

Gun "SPRING" Schematic

CLEAN Spring

A div. of: 

ISO 9001:2008

Gun "SPRING" Schematic
Parts Reference Diagram
Page 1 - 1-800-366-3682

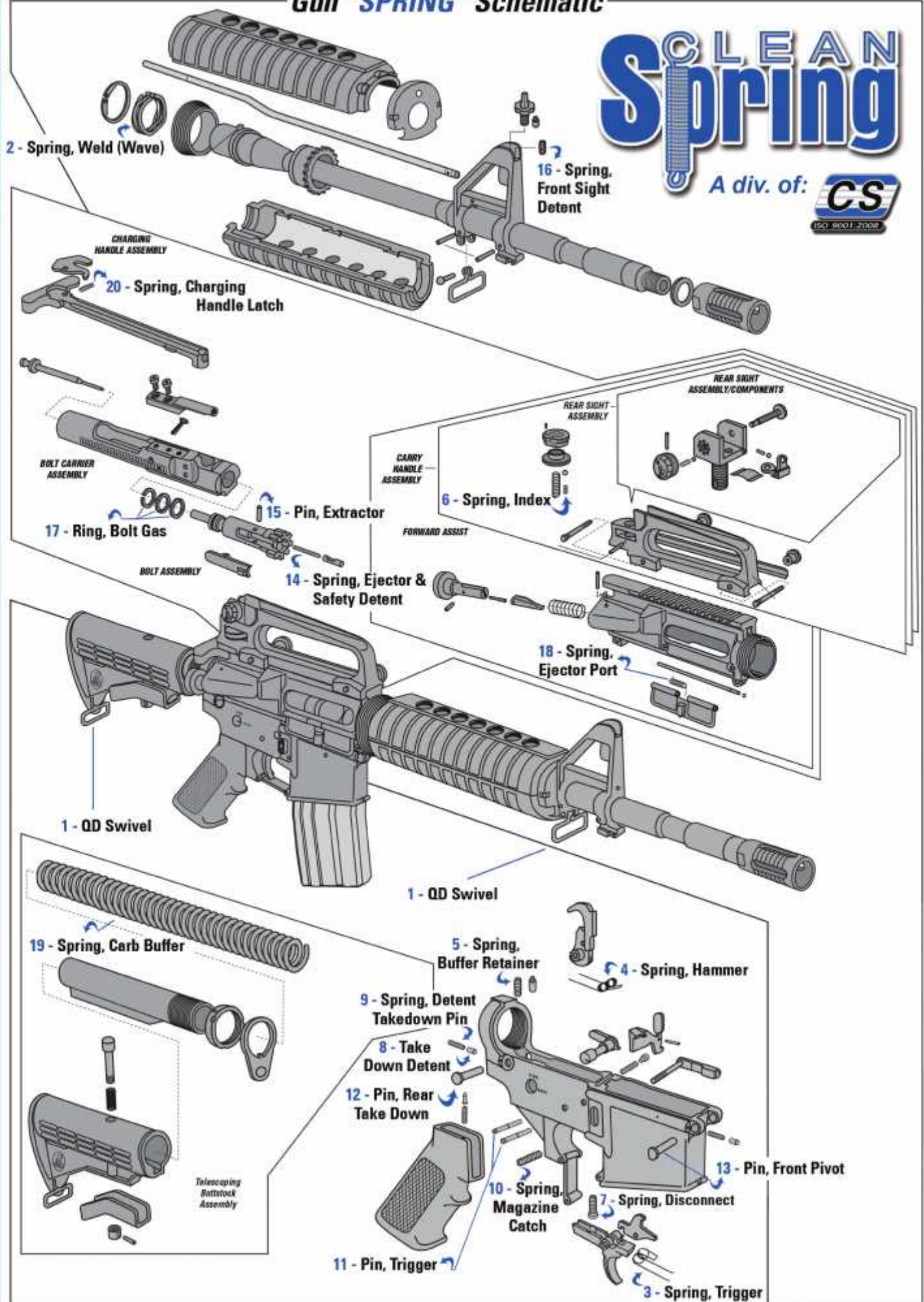

CHARGING HANDLE ASSEMBLY

BOLT CARRIER ASSEMBLY

CARRY HANDLE ASSEMBLY

REAR SIGHT ASSEMBLY

REAR SIGHT ASSEMBLY/COMPONENTS

BOLT ASSEMBLY

FORWARD ASSIST

Telescoping Buttstock Assembly

- 1 - QD Swivel
- 2 - Spring, Weld (Wave)
- 3 - Spring, Trigger
- 4 - Spring, Hammer
- 5 - Spring, Buffer Retainer
- 6 - Spring, Index
- 7 - Spring, Disconnect
- 8 - Take Down Detent
- 9 - Spring, Detent Takedown Pin
- 10 - Spring, Magazine Catch
- 11 - Pin, Trigger
- 12 - Pin, Rear Take Down
- 13 - Pin, Front Pivot
- 14 - Spring, Ejector & Safety Detent
- 15 - Pin, Extractor
- 16 - Spring, Front Sight Detent
- 17 - Ring, Bolt Gas
- 18 - Spring, Ejector Port
- 19 - Spring, Carb Buffer
- 20 - Spring, Charging Handle Latch

2 - Spring, Weld (Wave)

16 - Spring, Front Sight Detent

20 - Spring, Charging Handle Latch

17 - Ring, Bolt Gas

15 - Pin, Extractor

6 - Spring, Index

14 - Spring, Ejector & Safety Detent

18 - Spring, Ejector Port

1 - QD Swivel

1 - QD Swivel

19 - Spring, Carb Buffer

5 - Spring, Buffer Retainer

4 - Spring, Hammer

9 - Spring, Detent Takedown Pin

8 - Take Down Detent

12 - Pin, Rear Take Down

10 - Spring, Magazine Catch

7 - Spring, Disconnect

3 - Spring, Trigger

11 - Pin, Trigger

13 - Pin, Front Pivot